

15<sup>TH</sup> ANNUAL CONFERENCE  
KANSAS ASSOCIATION  
OF MAPPERS

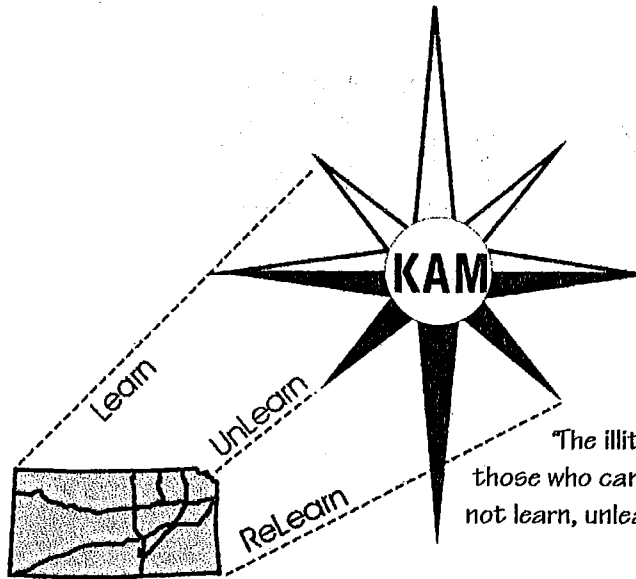

*"The illiterate of the 21st century will not be those who cannot read and write, but those who cannot learn, unlearn, and relearn"* Alvin Tofler

**— MAPPING IS A JOURNEY —**

**TRAVEL  
GUIDE**



**--MAPPING IS A JOURNEY--**

**\* THANK YOU \* THANK YOU \* THANK YOU**

*We must take this opportunity to say 'Thanks!' to those businesses, organizations and individuals who have supported the efforts of KAM and the annual conference. Without the contributions of these sponsors, the conference would not be possible. We encourage everyone to support them in return.*

**Stellar Sponsors:**



ESRI



MARKHURD

MJ Harden



ProMap Corporation

Shafer, Kline & Warren



**Star Sponsors:**



Drexel  
Intergraph



KBP Reprographics  
Mid-Kan BlueLine, Inc  
Western Air Maps



**Luminary Sponsor:**



Data Access & Support Center

**Special Recognition:**

*City of Wichita*—Furnishing the training facility for a class.

*Peter Veenstra*—Providing the instruction for the Visual Basics class.

**HYATT** *Hyatt Regency-Wichita*  
Wichita, Kansas  
Donation of the grand prize and providing endless hours coordinating this function. Special thanks to *Kay Huffstetler*, Convention Manager.

*Topeka BlueLine*  
Our thanks for donating printing services. *Topeka Blueprint Company, Inc.*  
When you think of copies... think of us.

*Wichita Conventions & Visitors Bureau*  
 Providing a door prize for our conference.

*Applebees Neighborhood Grill & Bar*  
Donating a door prize for a lucky attendee.

*Black Canyon ~ Oldtown*  
Providing a door prize for our event.

**--MAPPING IS A JOURNEY--**  
**ITINERARY**

Schedule of Events

Monday, Sept. 25

- |       |   |                   |
|-------|---|-------------------|
| 10:30 | Welcome—Brenda Krause<br>Keynote Address—Nancy Von Meyer, Fairview Industries   | 209A              |
| 12:00 | Luncheon<br>Committee Reports<br>Certification/Designation—Melissa Newton-Blume<br>Awards—<br>Nomination—Tom Brown<br>Membership—Trisha Brush<br>Exhibitor Introductions<br>Speaker—Adele Haft, associate professor, Hunter College, CUNY | 203               |
| 2:30  | Mapping & Cartography: Looking Back —Dr McCleary  | 209A              |
| 3:30  | Sessions<br>Hold GIS in Your Hand—Trisha Brush<br>Modeling Cadastral Parcels—Nancy Von Meyer<br>Design & Layout of Maps—Susan Williams  | 204<br>205<br>208 |
| 6:00  | Exhibitor Reception<br>Meet with Exhibitors<br>View the Map Gallery<br>Enjoy food & friends<br>Win Prizes!  | 210               |



**Continuing Education Points**

Continuing Education Certificates are available again this year. The KAM Education Committee has been working to provide this benefit to our members. To obtain your certificate, pick-up a voucher at the end of each eligible session. Between **4:30 & 5:00 p.m. Monday & Tuesday**, you may redeem your voucher for the actual certificates at the registration table. If you have any questions, please check with **Ellen Odom**.

**--MAPPING IS A JOURNEY--**  
**ITINERARY**

Schedule of Events

Tuesday, Sept. 26

8:30	Sessions	
	Putting Maps on the Web—Chris Welchhans	204
	Enterprise GIS—Jay Heermann	205
	ESRI Presentation	206
9:20	Sessions	
	Crime Analysis—Lori Wilkerson	204
	MARKHURD Presentation	205
	GPS Part I: Data Collection—Max Clark	206
10:15	Sessions	
	Updating the Soil Survey & KS River Bottoms—Bruce Evans	204
	History of Land Surveying—Craig Chaney & Ryan Branfort	205
	GPS Part II: Downloading to a Project—Max Clark	206
11:05	Sessions	
	Shafer, Kline & Warren Presentation	204
	History of Land Surveying—Craig Chaney & Ryan Branfort	205
	Enterprise GIS—Jay Heermann	206
11:45	Luncheon	210
	Voting	
	Education Committee report—Ellen Odom	
	Education Grant Update—Trisha Brush	
	Legislation & Standards Committee report—B J Wooding	
1:30	Managing Your Stress—Gary Withrow	209A
2:20	Sessions	
	Satellite Photos—Dr Ernie Paylor, NASA	204
	Ownership in Kansas—Scott Tabb	205
	MJ Harden Presentation	208
3:15	Sessions	
	Satellite Photos—Dr Ernie Paylor, NASA	204
	ProMap Corporation Presentation	205
	Crime Analysis—Lori Wilkerson	208
7:00	'Who Wants to Be a Millionaire' - All Mapping Edition <i>details on page 5</i>	off-site

**--MAPPING IS A JOURNEY--**  
**ITINERARY**

Schedule of Events

Wednesday, Sept. 27

9:00	Sessions	
	Lot Valuation—Melissa Newton-Blume	204
	Avenue & Visual Basic for Applications—Chris Welchans	205
	National Hydrography Dataset—Mark Coppersmith	208
9:50	Sessions	
	Ownership in Kansas—Scott Tabb	204
	Hold GIS in Your Hand—Trisha Brush	205
	Design & Layout of Maps—Susan Williams	208
10:45	Mapping & Cartography: Looking Ahead—Dr McCleary	210 B
12:00	Luncheon	210
	Business Meeting—install new officers	
	Closing Address—Linda Sibert	

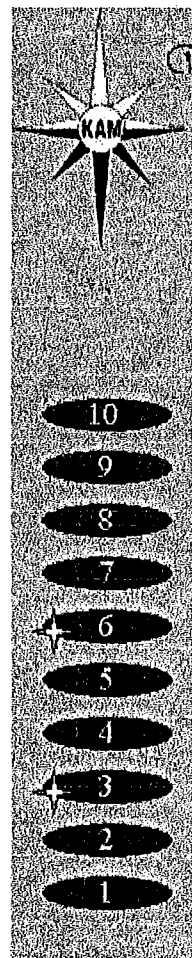

*Who Wants to Be a Millionaire - All Mapping Edition*

Experience the latest craze!  
The Blockbuster Hit Show  
"Who Wants to Be a Millionaire"  
Has arrived in time for the KAM conference  
Join 'Regis' at the Black Canyon Restaurant and be prepared for  
an evening full of fun, excitement and prizes.

Dinner is available in the downstairs dining room before the show.  
The lights come up on 'Regis' at 7:00 sharp upstairs!

Refreshments will be available during the show.  
Dinner and drinks are on you, the excitement is on us!



711 E Douglas Ave

# --MAPPING IS A JOURNEY--

## RESEARCH AN ITINERARY

### Session Descriptions

#### **Hold GIS in Your Hand**

Attend this class and look into the very near future. This class will offer a little bit of knowledge and fun for everyone! We will discuss and demo everything from a Casio hand held computer with Windows CE, to ArcPad, Access database and digital cameras that you can use with your hand held PC. Come to this class and hold the future in the palm of your hand.

#### **National Hydrography Dataset**

The National Hydrography Dataset is a comprehensive set of digital spatial data that contains information about surface water features such as streams, lakes, ponds, and rivers. The NHD was developed in cooperation with the EPA and is based on the content of the USGS Digital Line Graph hydrography data integrated with the EPA reach file information. Initially based on the content from the 1:100,000-scale USGS topography maps, Kansas is one of the first states to cooperate with the USGS to build state-wide high resolution NHD, based on the 1:24,000-scale topographic maps. This presentation will focus on the efforts of USGS and EPA to build the NHD, the content and format of the data files, and the status of the cooperative efforts between Kansas and USGS to build the high resolution NHD.

#### **Updating the Soil Survey & KS River Bottom**

This session will basically cover the historical mapping of the Kansas River. Along with the methodology and equipment used to complete a soil survey.

#### **Design and Layout of Maps**

This session will explore the basic elements of cartography and what information every map should include. Printing a map from our digital system is only part of the challenge. Making sure the reader knows what the lines and dots mean is another.

#### **Lot Valuation—Specifically Lot Sizing**

This session will cover basic lot sizing principles. Most lots are shaped in a way that readily lends them to the application of standard lot sizing procedures. This session will offer an explanation of those procedures.

#### **Ownership in Kansas**

Life estates, Trusts and Transfer on Death. Each of these and other types of ownership will be examined and explained. This session will answer who owns the property, when the ownership transfers and how to list them for tax purposes.

#### **Stress Management**

Who is in control, me or you?

This portion will speak to who is in charge of your emotions. The effect low self esteem has on stress.

My hands are getting warmer!

This portion will speak to bio-feed back and how that can help reduce stress.

#### **History of Surveying**

We plan to open this session beginning with the establishment of the Kansas-Nebraska line (40th Parallel) and setting of the initial point. Also will discuss the directions of the Survey General, the establishment of Guide Meridians, Standard Parallels, Township exterior boundaries and the subdivision of Townships. The presentation of this should or hopefully lead to the acknowledgment of errors produced in chainage compared to modern measuring techniques and problems with mapping.

#### **Avenue™ and Visual Basic® for Applications (VBA)**

Any ArcView® GIS users? No previous Avenue™ or Visual Basic® for Applications (VBA) experience is necessary. Since Avenue is a robust object-oriented programming language, understanding and applying these principles will make the transition to Visual Basic for Applications easier. VBA is the de facto scripting language for the new COM based release of ArcView 8.0. This session will build upon the basic principles of object-oriented programming languages by comparing examples of code and

#### **Putting Maps on the Web**

The Internet is one of the fastest growing mediums for sharing information. This session will present several options for publishing spatial information on the web. The talk will focus on current software products offered by Geographic Information System (GIS) software vendors, and will include examples of web applications built around interactive map displays. We will discuss some of the steps involved in creating a mapping application for the web including the relevant technologies, so that the participants will have a fundamental understanding of the process.

**--MAPPING IS A JOURNEY--**

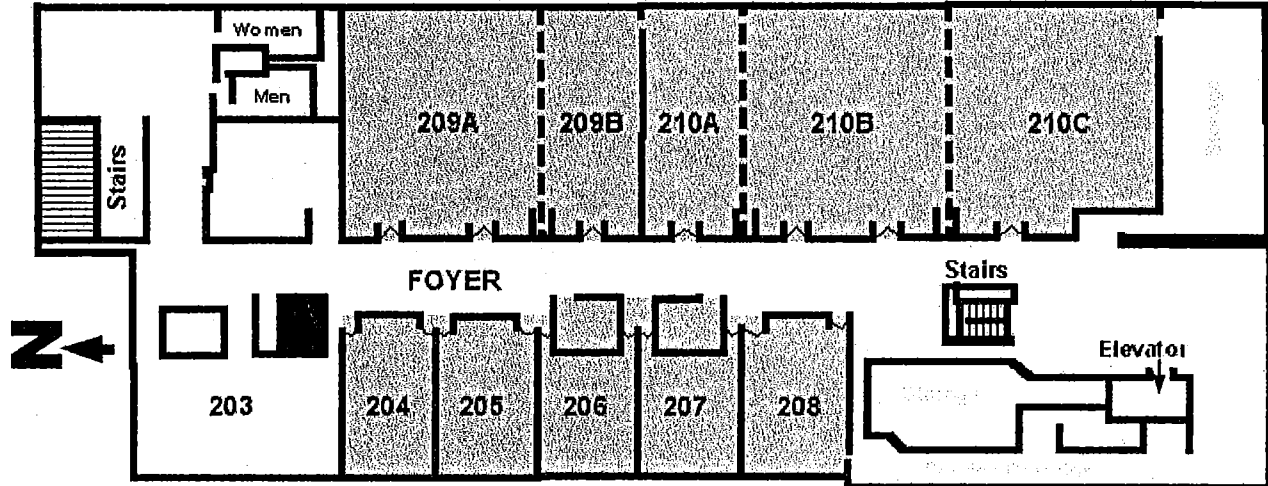

**!!! Grand Prize Giveaway !!!**

You will want to register for our grand prize to be raffled at the closing luncheon on Wednesday at noon. To be eligible to win, you must obtain a few essential items and check them in with Marcy along with this coupon.

Check the reverse of this coupon for a listing of items and complete rules.

*Please fill in this quick form*

NAME: \_\_\_\_\_

AFFILIATION/COUNTY: \_\_\_\_\_

SIGNATURES

KAM PRESIDENT (PAST OR PRESENT): \_\_\_\_\_

ONE KAM DIRECTOR: \_\_\_\_\_



# --MAPPING IS A JOURNEY--

## CONTINUING THE JOURNEY

*Here is your opportunity to help set the course for the future. Please take time to put some thought into the answers for this survey. If you would like to share a comment about the direction of KAM but the question is not represented here, please don't be shy! Use the back and let the board know what you are thinking. Every comment is read and considered.*

Please rate the sessions you attended. 1 is the top (excellent) and 5 will indicate poor. Space is provided for specific comments at the bottom of this column.

- Design & Layout of Maps ..... \_\_\_\_\_
- History of Surveying ..... \_\_\_\_\_
- Remote Sensing ..... \_\_\_\_\_
- Ag Applications and Mapping ..... \_\_\_\_\_
- Updating the Soil Survey & KS River Bottoms \_\_\_\_\_
- Stress Management Techniques ..... \_\_\_\_\_
- Satellite Imagery presented by NASA ... \_\_\_\_\_
- Enterprise GIS ..... \_\_\_\_\_
- Ownership & Source Documents ..... \_\_\_\_\_
- Lot Valuation—specifically “lot sizing” . \_\_\_\_\_
- Serving Maps to the Web ..... \_\_\_\_\_
- Handheld Computer Applications ..... \_\_\_\_\_
- Crime Analysis ..... \_\_\_\_\_
- GPS Part I & II ..... \_\_\_\_\_
- Hydrography ..... \_\_\_\_\_

Please share your comments on these issues:

Hotel:

*What do you feel is important when choosing a location for next year's conference?*

Food:

*What changes would you like to suggest?*

Conference as a whole:

Topics for the 2001 conference:

Suggestions for 2001 Conference:

Suggestions for the Web page ([www.kam.to](http://www.kam.to)):

*What else would you like to see on it, or how would you like to have it changed?*